

At-a-Glance Schedule



Conference on Discrete Mathematics

June 22–25, 2026 • University of California, San Diego, San Diego, California, U.S.

Online Program and Mobile App

Attendees are encouraged to view the Online Program Schedule:

<https://www.siam.org/conferences-events/siam-conferences/dm26/program/program-abstracts/>

The Mobile App and Online Program Schedule contain the most up-to-date information.
A searchable abstract document is also posted.

SIAM Events Mobile App



www.tripbuildermedia.com/apps/siam

siam | Society for Industrial and
Applied Mathematics

3600 Market Street, 6th Floor
Philadelphia, PA 19104-2688 U.S.
Telephone: +1-215-382-9800

Conference Email: meetings@siam.org • Conference Web: www.siam.org/conferences-events
Membership and Customer Service: (800) 447-7426 (U.S. and Canada) or +1-215-382-9800 (worldwide)
www.siam.org/conferences-events/siam-conferences/dm26

Monday, June 22

7:30 a.m. – 5:00 p.m.

Registration
The Jeannie Foyer

8:25 a.m. – 8:30 a.m.

Welcome Remarks
The Jeannie Auditorium

8:30 a.m. – 9:15 a.m.

IP1 Crossing Numbers: Dead or Alive?
János Pach, Alfréd Rényi Institute of Mathematics,
Hungary
The Jeannie Auditorium

9:15 a.m. – 9:45 a.m.

Coffee Break
The Jeannie Foyer

9:45 a.m. – 11:45 a.m.

Concurrent Sessions**MS1** Combinatorial Geometry*The Jeannie Auditorium***MS2** Extremal and Probabilistic Graph Theory -
Part I of III*AP&M B402, Basement level***MS3** New Perspectives in Algebraic Combinatorics*AP&M B412, Basement level***MS4** Trends in Additive Combinatorics and

Combinatorial Number Theory - Part I of II

AP&M 6402, 6th floor

11:45 a.m. – 1:30 p.m.

Lunch Break

1:30 p.m. – 2:15 p.m.

IP2 Improved Bounds for Sarkozy's Theorem
Mehtaab Sawhney, Columbia University, U.S.
The Jeannie Auditorium

2:15 p.m. – 2:45 p.m.

Coffee Break
The Jeannie Foyer

2:45 p.m. – 4:45 p.m.

Concurrent Sessions**MS5** Extremal and Probabilistic Combinatorics -
Part I of III*The Jeannie Auditorium***MS6** Extremal and Probabilistic Graph Theory -
Part II of III*AP&M B402, Basement level***MS7** Trends in Additive Combinatorics and

Combinatorial Number Theory - Part II of II

*AP&M 6402, 6th floor***CP1** Algebraic Combinatorics I*AP&M B412, Basement level*

Monday, June 22

4:45 p.m. – 5:00 p.m.

Intermission

5:00 p.m. – 7:00 p.m.

Welcome Reception
Faculty Club Dining Room

Tuesday, June 23

7:30 a.m. – 3:00 p.m.

Registration
The Jeannie Foyer

8:25 a.m. – 8:30 a.m.

Announcements
The Jeannie Auditorium

8:30 a.m. – 9:15 a.m.

IP3 Graphs with High Chromatic Number
Penny Haxell, University of Waterloo, Canada
The Jeannie Auditorium

9:15 a.m. – 9:45 a.m.

Coffee Break
The Jeannie Foyer

9:45 a.m. – 11:45 a.m.

Concurrent Sessions**MS8** Extremal and Probabilistic Combinatorics -
Part II of III*The Jeannie Auditorium***MS9** Extremal and Probabilistic Graph Theory -
Part III of III*AP&M B402, Basement level***MS10** Discrete Mathematics Uses and Theory of the

Ranks of Tensors - Part I of II

*AP&M 6402, 6th floor***CP2** Applied Combinatorics II*AP&M B412, Basement level*

11:45 a.m. – 1:30 p.m.

Lunch Break

1:30 p.m. – 2:15 p.m.

SP1 2026 Dénes König Prize Lecture: High-Girth
Steiner Triple Systems
Ashwin Sah, Massachusetts Institute of Technology,
U.S.
The Jeannie Auditorium

2:15 p.m. – 2:45 p.m.

Coffee Break
The Jeannie Foyer

Tuesday, June 23

2:45 p.m. – 3:30 p.m.

IP4 Clustering Coefficients of Graphs
Fan Chung, University of California, San Diego,
U.S.*The Jeannie Auditorium*

3:30 p.m. – 3:45 p.m.

Intermission

3:45 p.m. – 5:45 p.m.

Concurrent Sessions**MS11** Extremal and Probabilistic Combinatorics -
Part III of III*The Jeannie Auditorium***MS12** Random Discrete Structures*AP&M B402, Basement level***MS13** Discrete Mathematics Uses and Theory of the

Ranks of Tensors - Part II of II

*AP&M 6402, 6th floor***CP3** Extremal Combinatorics*AP&M B412, Basement level*

Wednesday, June 24

7:30 a.m. – 3:00 p.m.

Registration
The Jeannie Foyer

8:25 a.m. – 8:30 a.m.

Announcements
The Jeannie Auditorium

8:30 a.m. – 9:15 a.m.

IP5 Random Regular Graphs and the Kim-Vu
Sandwich Conjecture

Richard Montgomery, University of Warwick,

United Kingdom

The Jeannie Auditorium

9:15 a.m. – 9:45 a.m.

Coffee Break
The Jeannie Foyer

9:45 a.m. – 11:45 a.m.

Concurrent Sessions**MS14** Graph Structure - Part I of III*The Jeannie Auditorium***MS15** Extremal and Probabilistic Design Theory -
Part I of III*AP&M B402, Basement level***MS16** Algorithms Methods and Applications in
Neuroscience and Neuromorphic Computing - Part I
of II*AP&M 6402, 6th floor*

Wednesday, June 24**Thursday, June 25****CP4** Graph Theory

AP&M B412, Basement level

11:45 a.m. – 1:30 p.m.

Lunch Break

1:30 p.m. – 2:15 p.m.

IP6 A Survey of Coarse Graph Theory

James Davies, University of Leipzig, Germany

The Jeannie Auditorium

2:15 p.m. – 2:45 p.m.

Coffee Break

The Jeannie Foyer

2:45 p.m. – 4:45 p.m.

Concurrent Sessions**MS17** Graph Structure - Part II of III*The Jeannie Auditorium***MS18** Extremal and Probabilistic Design Theory - Part II of III

AP&M B402, Basement level

MS19 Algorithms Methods and Applications in Neuroscience and Neuromorphic Computing - Part II of II

AP&M 6402, 6th floor

CP5 Extremal Graph Theory

AP&M B412, Basement level

4:45 p.m. – 5:00 p.m.

Intermission

5:00 p.m. – 5:45 p.m.

SIAG/DM Business Meeting

Complimentary beer and wine will be served.

The Jeannie Auditorium

9:15 a.m. – 9:45 a.m.

Coffee Break

The Jeannie Foyer

9:45 a.m. – 11:45 a.m.

Concurrent Sessions**MS20** Graph Structure - Part III of III*The Jeannie Auditorium***MS21** Extremal and Probabilistic Design Theory - Part III of III

AP&M B402, Basement level

MS22 Combinatorics of Evolutionary Trees and Networks - Part I of II

AP&M 6402, 6th floor

11:45 a.m. – 1:30 p.m.

Lunch Break

The Jeannie Foyer

1:30 p.m. – 2:15 p.m.

IP8 Refined Absorption and Applications to

Probabilistic and Extremal Design Theory

Michelle Delcourt, Toronto Metropolitan University, Canada

The Jeannie Auditorium

2:15 p.m. – 2:20 p.m.

Closing Remarks

The Jeannie Auditorium

2:20 p.m. – 2:50 p.m.

Coffee Break

The Jeannie Foyer

2:50 p.m. – 4:50 p.m.

MS23 Combinatorics of Evolutionary Trees and Networks - Part II of II

AP&M 6402, 6th floor

Thursday, June 25

7:30 a.m. – 3:00 p.m.

Registration

The Jeannie Foyer

8:25 a.m. – 8:30 a.m.

Announcements

The Jeannie Auditorium

8:30 a.m. – 9:15 a.m.

IP7 On the Structure of Sets of Bounded VC₂-dimension in Elementary Abelian p-groups

Caroline Terry, University of Illinois, Chicago, U.S.

*The Jeannie Auditorium***Abbreviation Key**

CP = Contributed Presentation Session

IP = Invited Plenary Speaker

MS = Minisymposium

SP = Special Lecture

**FUNDING AGENCY**

SIAM and the Organizing Committee wish to extend their thanks and appreciation to the U.S. National Science Foundation for their support of this conference.

University of California, San Diego DM26 Campus Map



DM26 – Applied Physics and Mathematics (AP&M) Building Floorplan

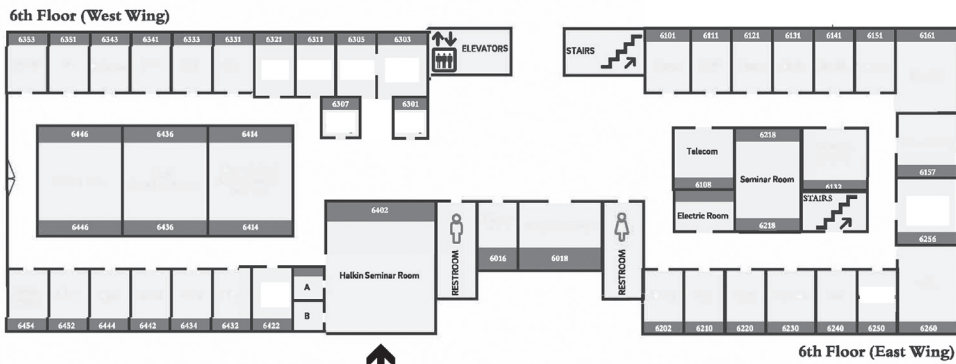

DM26 concurrent sessions (Room 6402)

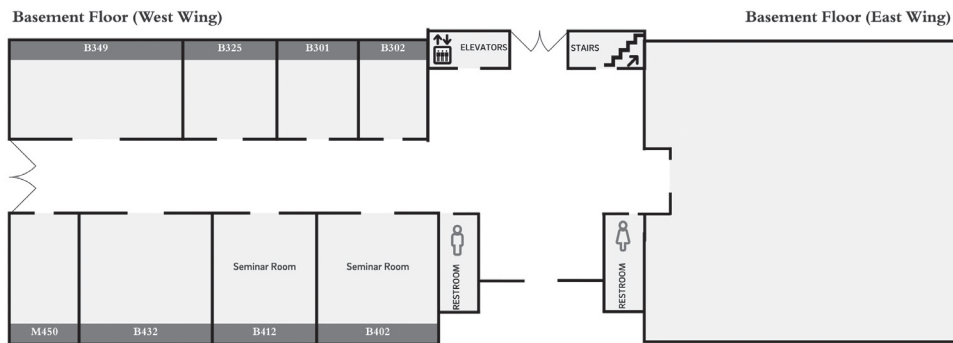

DM26 concurrent sessions (Rooms B412 and B402)